

*Internal wedge cut out of base course to access vertical rods*

*Supercrete™ block base course packer 600 x 200 x 50 or 600 x 200 x 100 depending on wall thickness. Refer to Floor Rebate Types Detail BLK-2.0*

### BASE COURSE SETOUT FOR 250 & 300mm SUPERCRETE™ BLOCK

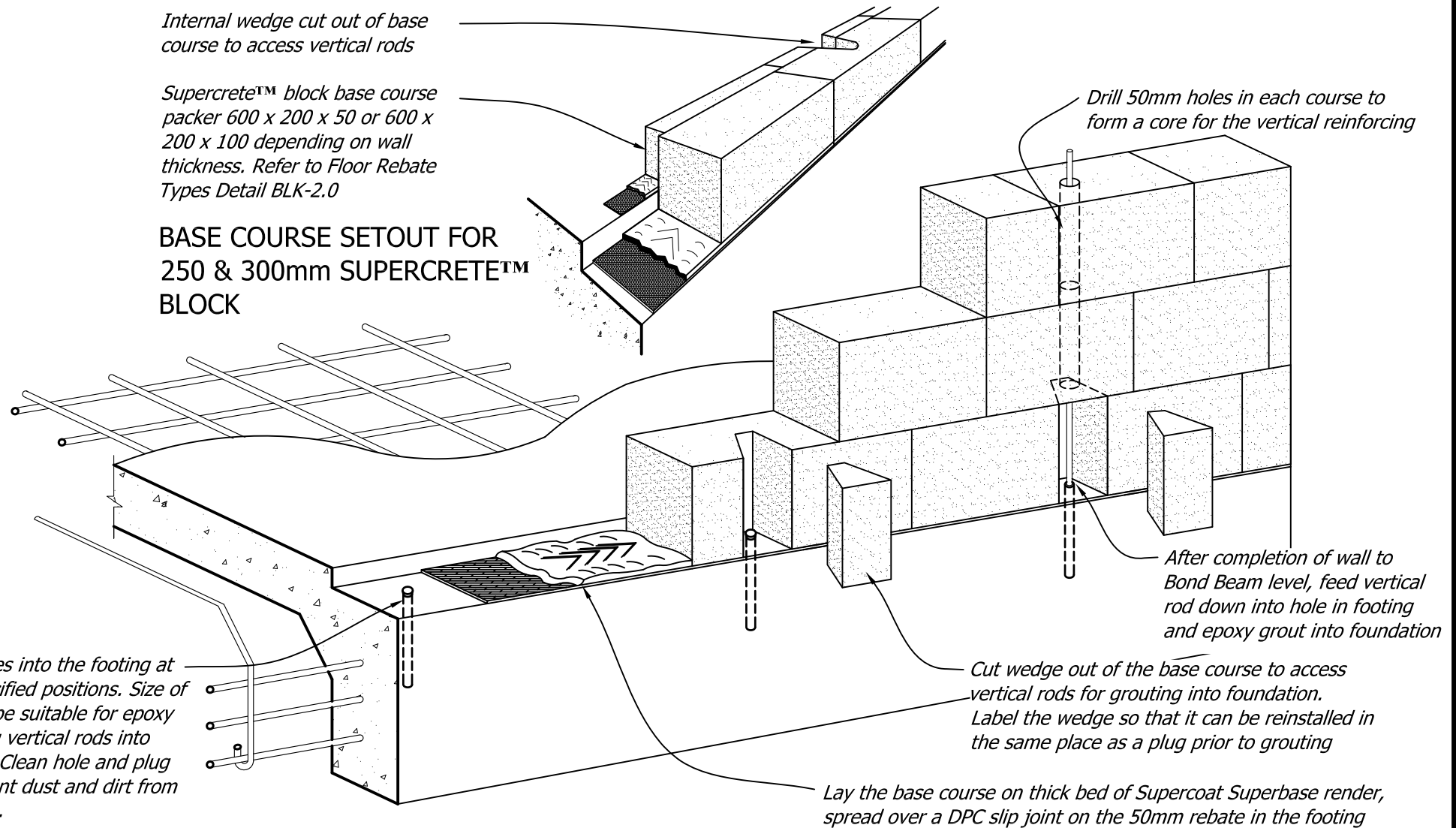

*Drill holes into the footing at the specified positions. Size of hole to be suitable for epoxy grouting vertical rods into footing. Clean hole and plug to prevent dust and dirt from entering.*

*Cut wedge out of the base course to access vertical rods for grouting into foundation. Label the wedge so that it can be reinstalled in the same place as a plug prior to grouting*

*Lay the base course on thick bed of Supercoat Superbase render, spread over a DPC slip joint on the 50mm rebate in the footing*

*After completion of wall to Bond Beam level, feed vertical rod down into hole in footing and epoxy grout into foundation*

*Drill 50mm holes in each course to form a core for the vertical reinforcing*

### BASE COURSE SETOUT FOR 200mm SUPERCRETE™ BLOCK

Copyright © Superbuild International Ltd 2013

**Supercrete™**

Title:

## Base Course Setout for External Block Walls - 3D View

**BLOCK CONSTRUCTION**

Date: **September 2013**

Scale: **NTS**

Drawing Reference: **BLK-1.3**

This drawing must be read in conjunction with the Supercrete Block Design Guide