

NOTE
 All gaps between wall and frame to be filled with
 Hilti CP 611A intumescent Firestop Mastic or
 equivalent

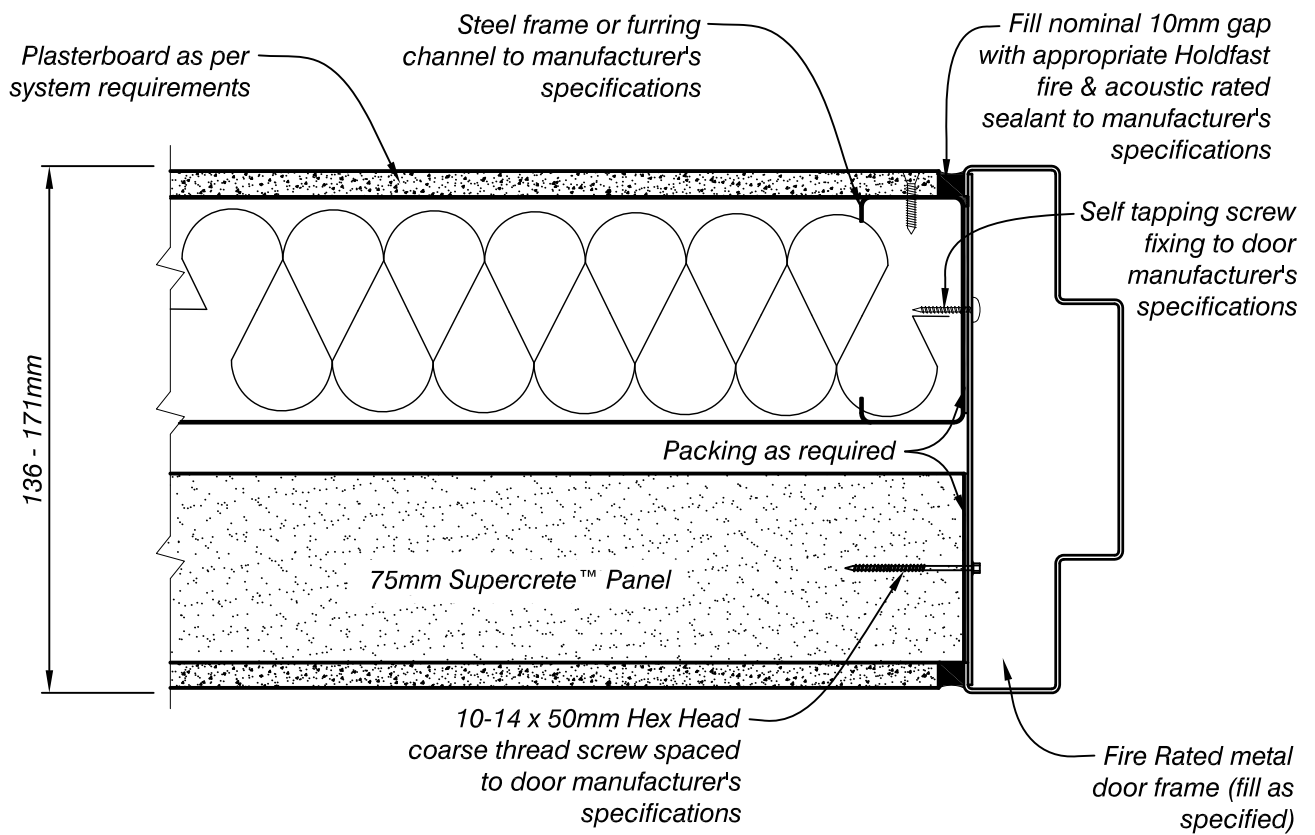

IMPORTANT

1. All door frame installations and detailing to be approved by door frame manufacturer
2. Continuously screw fix door frame to Supercrete™ Panel around perimeter of door opening.
3. Supercrete™ recommends core filling of the door frame for additional robustness
4. Fix door frame at the base

Supercrete™

Title: A.W.S. - Typical Fire Door or similar
 for Type 2 Wall

Date: December 2013

Scale: N.T.S.

Detail No. 10.6.3

This drawing must be read in conjunction with the Supercrete Acoustic Wall Systems Design Guide