

Grout filled longitudinal ring anchors

Supercrete™ Structural Floor Panels

M12 or D12 dowel pin vertical reinforcing rods grouted into Ø50mm drilled holes at 600mm centres max. (1 per panel)

Steel support beam as specified by project engineer

If upper storey wall is to be constructed above, the vertical rods are to be installed and epoxy grouted into floor panels separately

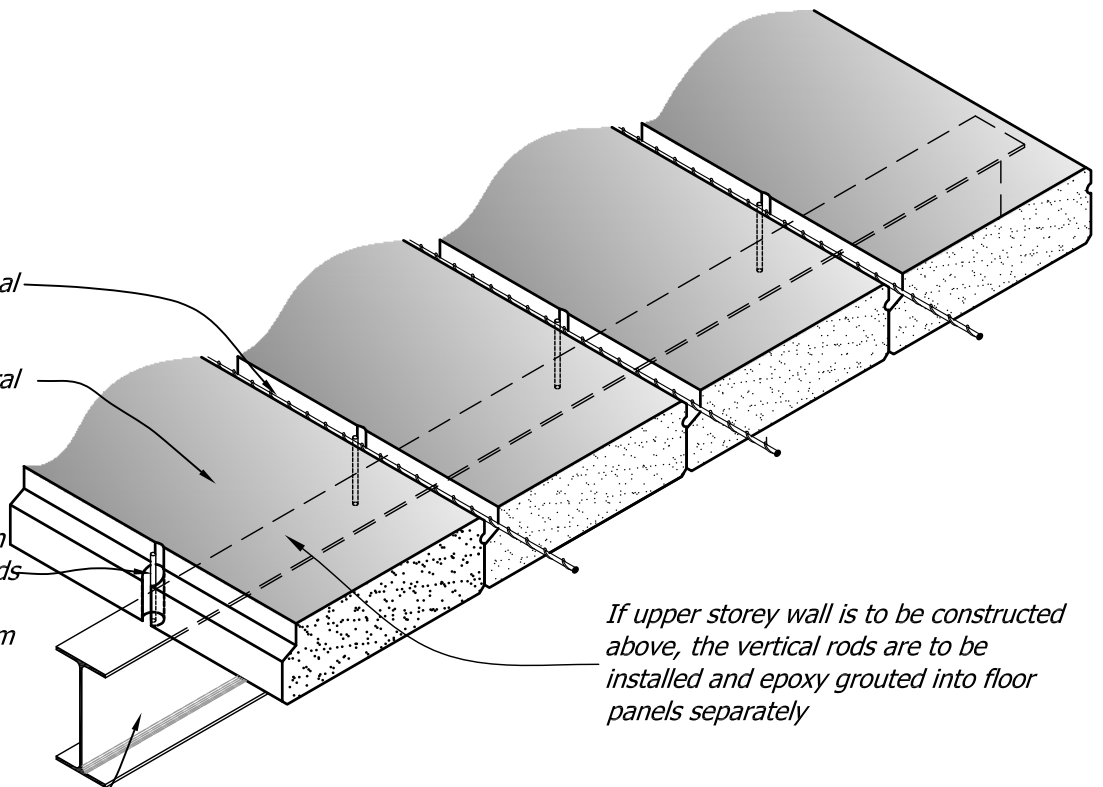

Copyright © Superbuild International Ltd 2013

Supercrete™

SFP CONSTRUCTION

Title: **Supercrete™ Structural Floor Panels
over Mid-span Support Beams**

Date: September 2013

Scale: N.T.S.

Detail No. **SFP 2-15**

This drawing must be read in conjunction with all the Supercrete Structural Floor Panels Design Guide