

Supercoat™ Tanking Mesh  
embedded into wet 1st coat of  
Supercoat™ tanking membrane

1st Coat of Supercoat™ Tanking  
Membrane

Selected Supercoat™ base coat

Supercrete™ Parapet capping  
block with top sloped at 5°  
minimum towards roof & glued  
to block below with Supercoat™  
Superbond Adhesive

Apron flashing turned into  
chase cut in block. Fill cavity  
with sealant

φ12 vertical rods grouted into a  
50mm φ hole & carried 75mm  
into capping block

Cast in-situ concrete  
Bond Beam

Typically 2 / D12  
longitudinal rods  
in Bond Beam  
(Engineer to design)

Supercrete™ Block external wall

Supercoat™ paint

Selected Supercoat™ texture  
coat

2nd coat of Supercoat™  
Tanking Membrane. Top coat to  
be Supercoat™ Tanking  
Membrane Keycoat

Finish tanking & coating to top  
of flashing

0.55mm Coloursteel apron  
flashing or similar

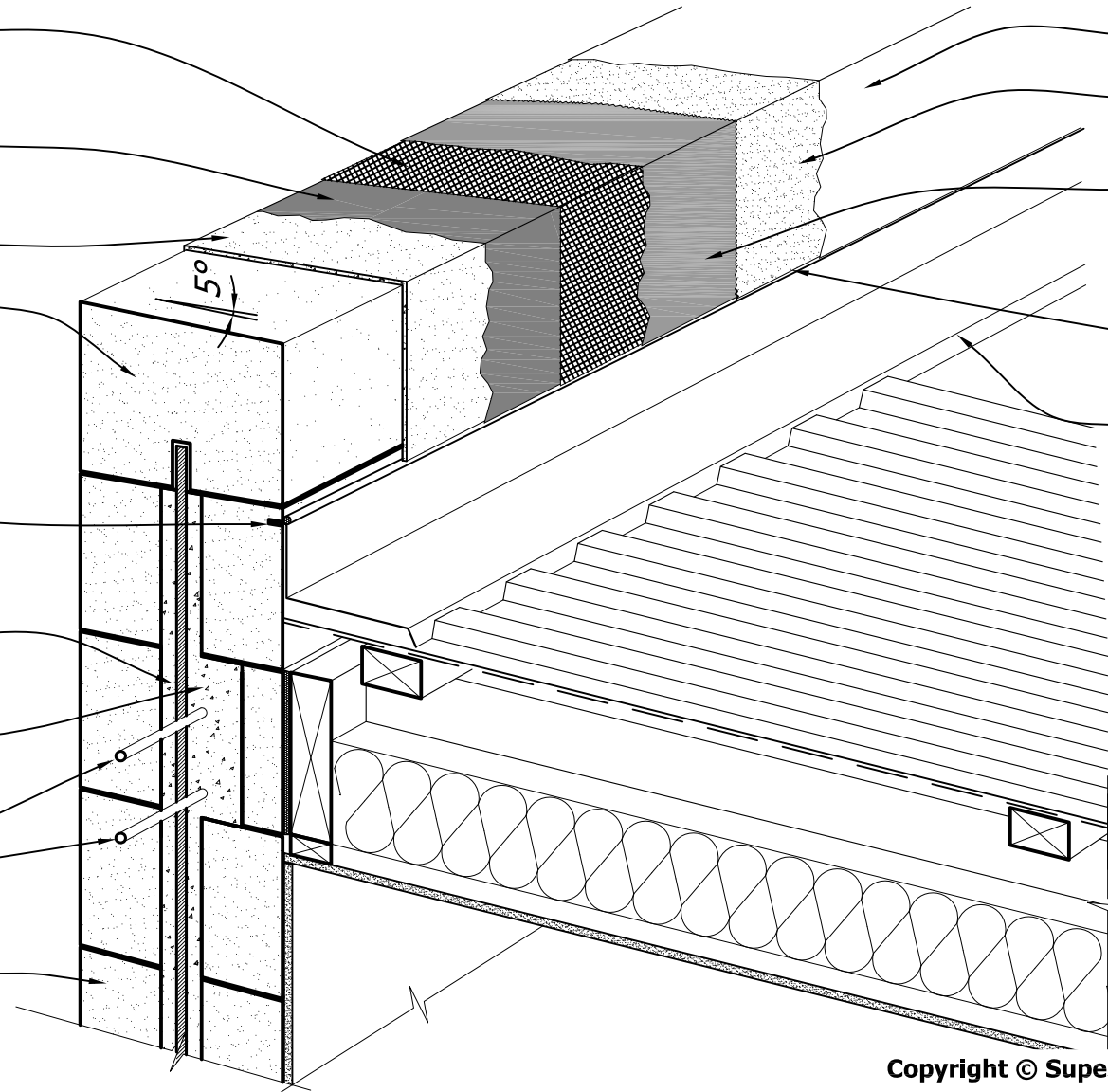

Copyright © Superbuild International Ltd 2013

**Supercrete™**

Title:

**Typical Parapet Detail-3D View**

**BLOCK CONSTRUCTION**

Date: **September 2013**

Scale: **NTS**

Drawing Reference: **BLK-1.8**

This drawing must be read in conjunction with the Supercrete Block Design Guide